

PACKAGE			
PART NO	FEET	(M)	(m/m)
P0.864~P5.94	1000	(304.8)	(304800)
P6.68~P11.1B	500	(152.4)	(152400)
P12.7B			
P11.1	500	(76.2)	(76200)
P12.7			

PART NO (ϕ D)	SIZE AWG	INSIDE DIAMETER	CAT.NO.DEV-300(300V.105°C)			CAT.NO.DEV-600(600V.105°C)		
			OUTSIDE DIAMETER	AVG THICKNESS	MIN THICKNESS AT ANT POINT	OUTSIDE DIAMETER	AVG THICKNESS	MIN THICKNESS AT ANT POINT
P0.864	20	0.864	1.70	0.40	0.330	2.10	0.60	0.431
P0.965	19	0.965	1.80			2.20		
P1.067	18	1.067	1.90			2.30		
P1.19	17	1.19	2.00			2.60	0.70	0.559
P1.34	16	1.34	2.15			2.75		
P1.50	15	1.50	2.30			2.90		
P1.68	14	1.68	2.50			3.10		
P1.93	13	1.93	2.70			3.35		
P2.16	12	2.16	3.00			3.60		
P2.41	11	2.41	3.20			3.80		
P2.69	10	2.69	3.50			4.10		

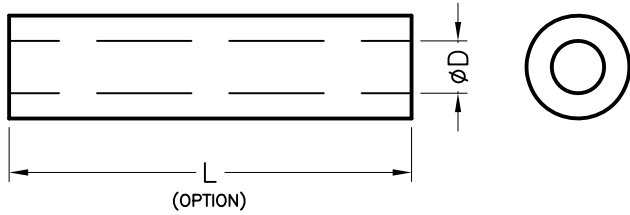

PART NO (ϕ D)	SIZE AWG	INSIDE DIAMETER	CAT.NO.DEV-300(300V.105°C)			CAT.NO.DEV-600(600V.105°C)		
			OUTSIDE DIAMETER	AVG THICKNESS	MIN THICKNESS AT ANT POINT	OUTSIDE DIAMETER	AVG THICKNESS	MIN THICKNESS AT ANT POINT
P3.00	9	3.00	4.10	0.55	0.431	4.40	0.70	0.559
P3.38	8	3.38	4.50			4.80		
P3.76	7	3.76	4.90			5.20		
P4.22	6	4.22	5.35			5.65		
P4.72	5	4.72	5.85			6.15		
P5.28	4	5.28	6.40			6.70		
P5.94	3	5.94	7.05			7.35		
P6.68	2	6.68	7.80			8.10		
P7.47	1	7.47	8.60			8.90		
P8.38	0	8.38	9.50			9.80		
P7.92	5/16"	7.92			9.35			
P9.53	3/8"	9.53			10.95			
P11.1	7/16"	11.1			12.50			
P12.7	1/2"	12.7			14.10			